



Product details

09 15 007 3101

Female insert, R 15

Series	R15
Number of contacts	7 poles + PE
Size of hood/housing	R15
Termination	Crimp termination
Insert material	Standard material
Contacts	Order separately
Housing material	Plastic
Electrical data	10 A 250 V 4 kV 3
RoHS compliant	Yes

1 2 3 4 5 6

A

B

C

D

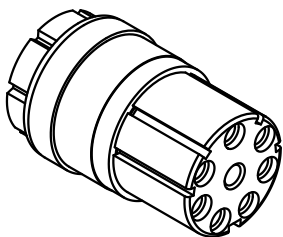
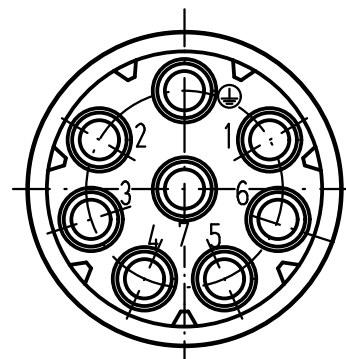
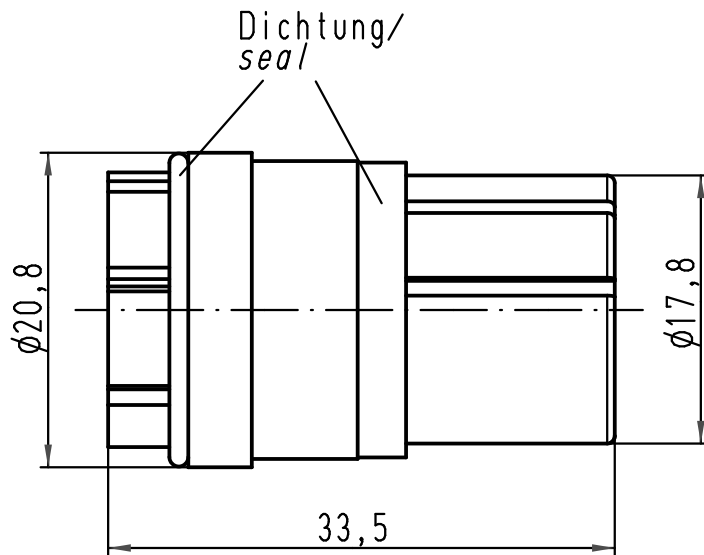

All Dimensions in mm Original Size DIN A 4			Techn. Character.			Nicht tolerierte Maße/Free size tolerances		
			Dat.	Name	Maßstab/Scale 2:1	R 15-7-F-c Buchseneinsatz/ female insert		
			Detail.	25.02.93 PENNER				
			Insp.	HERB				
			Stand.					
413155	27.08.07	Ho	HARTING Electric GmbH & Co. KG			TB 09 15 007 3101		
25592	22.03.99	PL	D-32339 Espelkamp					
Mod.	Dat.	Name				Sub. TB 09 15 007 3101 v. 12.12.87		
						Blatt/page		